

David Broadwell-NOUVEAU SCEPTRE — Twist Ball Point Pen Kit

KIT FEATURES

- Antique Art Nouveau style
- 22kt Gold plate accents
- Schmidt™ tungsten carbide ball point refill
- Elegant, casted 3-dimensional design
- Overall length: 5-1/2"

REQUIRED ACCESSORIES

- 7mm, Pen Mandrel
- 10mm Drill Bit #PK10-10 (lower tube)
- .0492" Drill Bit #PKPLI-DB (upper tube)
- 3-piece Bushing Set #PKDBBUB
- Barrel Trimmer Sleeves #PKDBTSB (Use with 7mm Barrel Trimmer)
- #PKDBBPSET—Set includes Bushings, Trimming Sleeves and .492" Drill Bit
- Insta-cure (cyanoacrylate) glue or 2-part epoxy glue



DIAGRAM A • Ball Point Twist Pen Parts

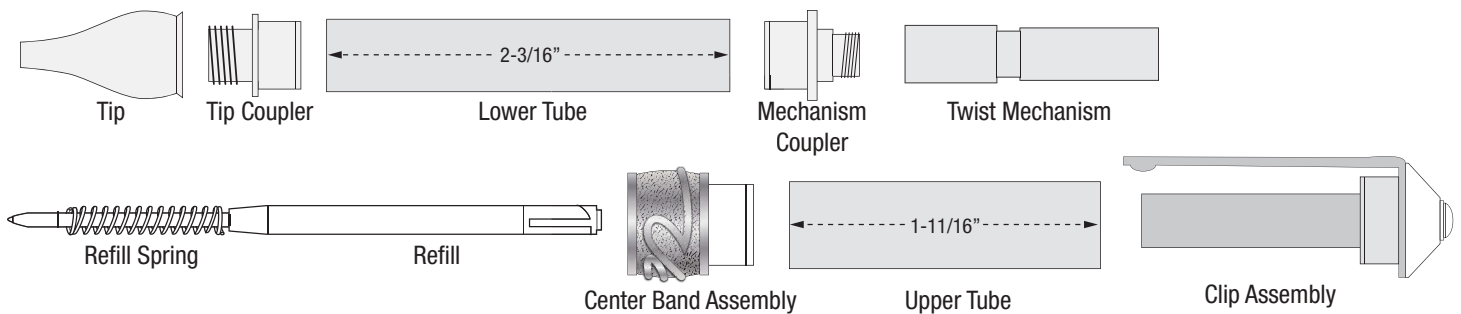

PREPARING THE BLANKS

- Cut 3/4" or larger square blank to the length of the brass tube. Add 1/16" to the length for squaring off.
- Using the .492" Drill Bit, drill a hole through the upper blank. Drill a 10mm hole through the lower blank.
- Apply glue to each tube and insert into the proper blank with a twisting motion to spread the glue evenly inside. Center the tube in each blank. Allow glue to dry completely.
- Trim the upper blank end using a 7mm barrel trimmer with the proper trimmer sleeve, and a 10mm trimmer for the lower blank. Trim the wood blank flush with the brass tube.

TURNING THE BLANKS

- Place spacer bushings onto the mandrel shaft. Insert the lager end bushing, large end first. Follow with the upper blank.
- Place the center bushing, large diameter in first, follow with the lower blank. Insert the smaller diameter bushing, small end first. Insert spacer bushings to close the space to the threads on the mandrel.
- Mount the locknut hand tight. Bring the tail stock snug to the mandrel shaft. Lock in place. Lock the knurled nut hand tight. Do not over tighten, it may bend the mandrel.

DIAGRAM B • Turning The Blanks

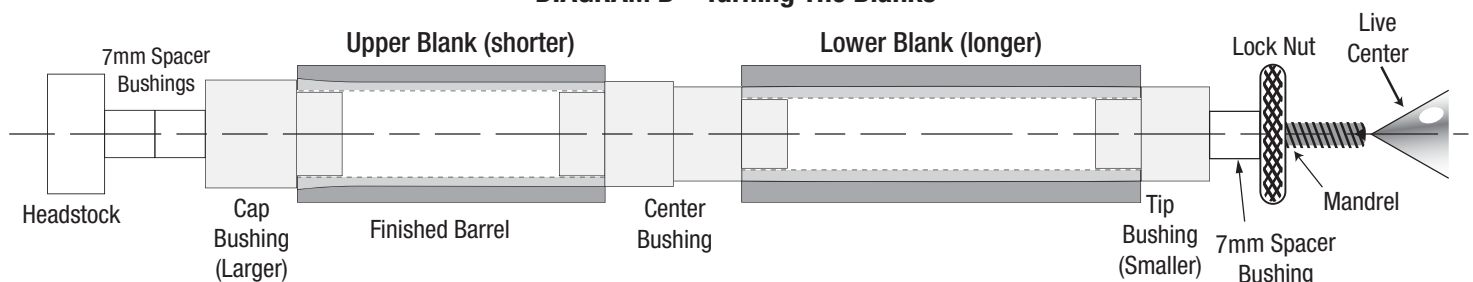
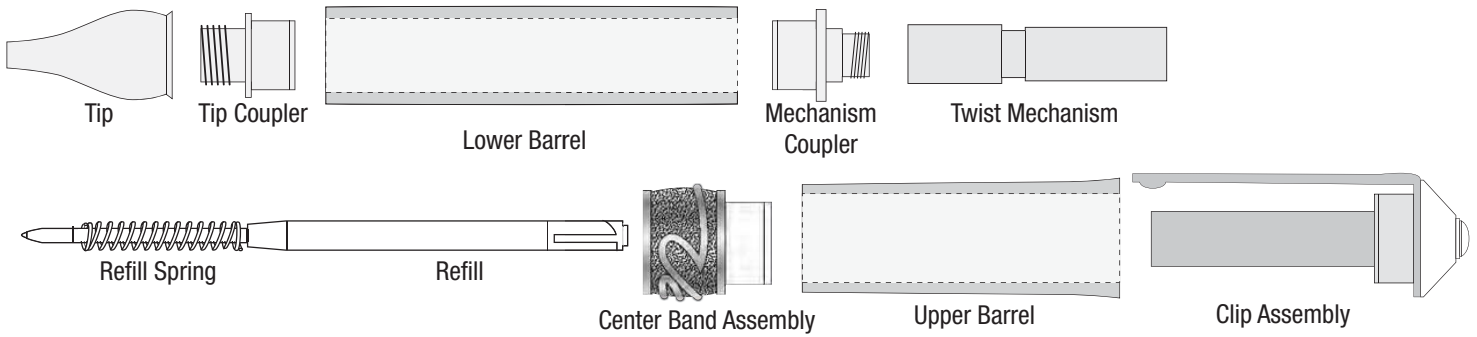

DIAGRAM C • Assembly — Ball Point Twist Pen



- Turn the wood down to the profile design illustrated in DIAGRAM B. Sand the blanks down to match the bushings.
- Finish the barrels with your choice of PSI Polish.

ASSEMBLY — Twist Ball Point Pen

- Line up the parts according to DIAGRAM C.
- Press the cap assembly into the wide end of the upper barrel.
- Slide and press in the center band assembly into the opposite end of the barrel.
- Press the mechanism coupler, recessed end in first into the larger diameter of the lower barrel.
- Press the tip coupler, recessed end first into the opposite end of the barrel (smaller diameter).
- Screw on the tip over the tip coupler.
- Slide the spring over the refill and insert the refill into the opening at the opposite end of the barrel.
- Screw on the twist mechanism over the refill end. Twist the mechanism to check operation.
- Engage the 2 halves of the pen. The pen operates by twisting to advance or retract the refill.

BUSHINGS

DIAGRAM D • BUSHINGS and BARREL TRIMMER SLEEVES

#PKDBBUB — BROADWELL Ball Point Twist Pen Bushings

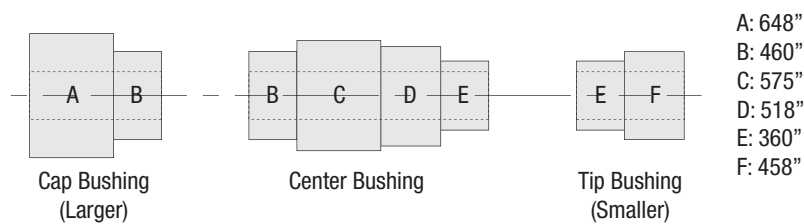

#PKDBTSB — Barrel Trimmer Sleeves

