

STAINLESS STEEL BOTTLE OPENER

Instructions

Kit Features

- Stainless steel finish

Required Accessories & Materials

- Bottle stopper screw chuck kit (PK-BS1-MJ) for 1"x 8tpi lathe or chuck kit with adapter for (PK-BS1-M) for 3/4"x16tpi lathe
- 23/64" drill bit (included in PK-BS1 kits above)
- Optional Tap Set (BSTAPSET)
- Glue (We recommend the thick "gel" CA glue—GTHICK2)
- Sanding and finishing supplies

Diagram A - Parts and Assembly

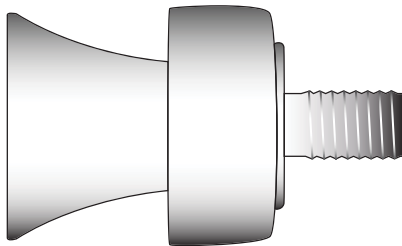
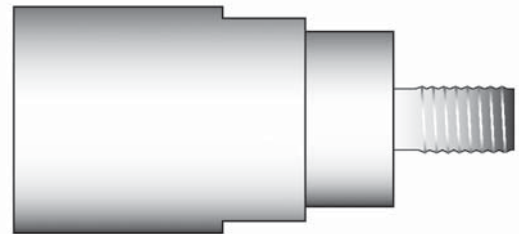

Diagram B - Lathe Chuck



BLANK PREPARATION

The blank size will vary based on your top profile design. Generally, the size of your wood or acrylic blank should be 1-1/2" x 1-1/2" x at least 2" long. Mark the center of the blank on the end. Using a medium drill speed, drill a 23/64" diameter hole 3/4" deep. Raise the bit from the wood every 1/4" to 1/2" to allow the chips to clear from the flutes of the drill bit. Don't force the drill bit; use an even pressure and let the bit do the work. If you are working with a soft wood, you may wish to use a slightly smaller drill bit. If using a harder wood, try a slightly larger bit.

OPTIONAL USE OF A TAP SET: Instead of drilling a 23/64" hole, drill a 5/16" hole and tap a 3/8" x 1/16tpi thread.

TURNING THE OPENER

Set up the mandrel as shown in Diagram C. Screw the wood or plastic blank onto the chuck's threaded end into the hole you drilled. You can use a wrench on the flats milled into the chuck to tighten. Mount the screw chuck onto your lathe. Now secure

the blank by engaging the tailstock live center for support. Your blank is now ready to turn. Once you have rounded the blank to remove the edges, the tailstock can be removed from the lathe while you continue turning.

Turn the blank to your own profile design. The bottom diameter at the base of the piece may be less than the chuck diameter, so measure the top of the opener to match the opener's outside diameter to be turned. Sand with abrasives and finish with your choice of polish.

ASSEMBLY

WoodTurningz recommends using thick CA glue when assembling the bottle opener. Spread glue over the threads of the opener. Be sure not to get any glue on the opener. Screw the piece onto the opener to secure. When dry, the opener is ready to use.

Diagram C - Turning the Opener

